

GSatSolarSeries

Quick Start Guide

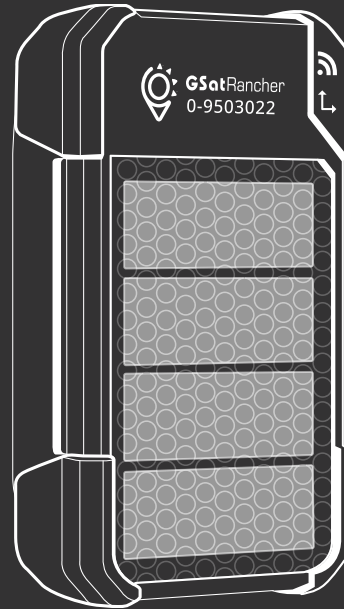
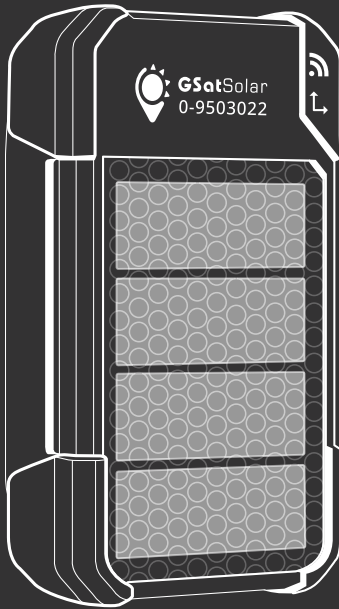

Track anything under the sun.

STEP 1 Preliminary Setup

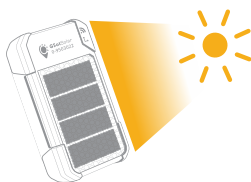

Getting Started

Contact your provider to ensure the device is activated and added to your tracking portal.

Start Your Device Transmitter:

Place your device in direct sunlight with the solar panel face up for at least 2-6 hours.

STEP 2 Before Mounting



Install the Mobile App

Visit the Google Play Store or Apple App Store to install the **GSatSolar** mobile app.

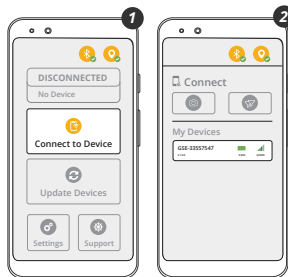

Connecting the Device

1. Open the GSatSolar app and select **"Connect to Device"**.
2. Select the appropriate device from the list confirming the battery icon is **green** and the signal strength is **"GOOD"** or **"GREAT"**.
3. The application will automatically connect to the selected device.

STEP 3 Verification

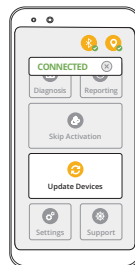

1. Select **"Details"** to ensure the reporting rate, battery status, and the device is using the latest firmware. If outdated, return to the previous screen and select **"Update Devices"**, choose the device, select **"Begin Update"**, and finally **"Confirm Update"**.
2. Place the device outside with a direct view of the sky. Log into the tracking portal supplied by your provider. The time your device takes to report will depend on its configuration. Wait for it to show on the map to verify that it is functioning.



WARNING: Do not alter the configuration settings as this may result in mixed device results and additional fees.

STEP 4 Mounting

Mount the device using the desired mounting option you discussed with your provider or as per the mounting guide.

Support & Resources

Visit <https://vetnfarm.com/tool-box/> for documentation and troubleshooting.