

# LB01F LEG BAND FOR GOATS

## Application Instructions

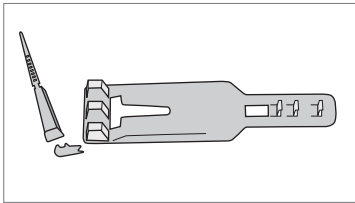

1. Separate the locking pin from the leg band

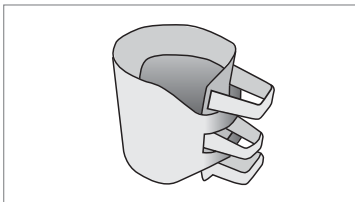

2. Wrap the band around the leg to determine the right size

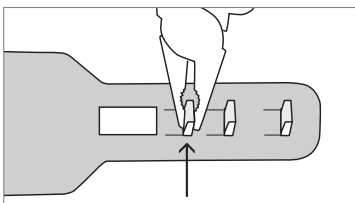

3. The leg band can be widened for a better fit by removing one or more of the three steps with a plier

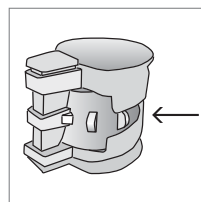
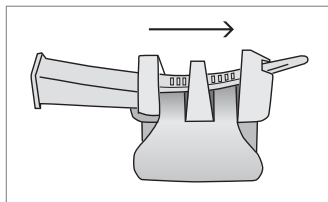
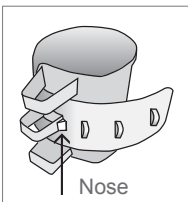

4. When wrapping the band around the leg, be sure to fit it in place using the 'nose' located on the center cavity (see illustration). Insert the locking pin through the three cavities, starting with the widest. Push the part remaining at the end of the band into the interior of the band, so that it does not stick out

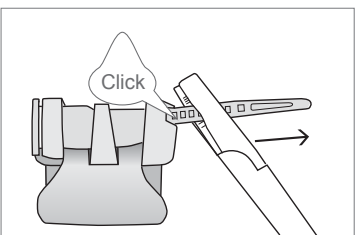

5. Pull the locking pin all the way over using a plier - at the end you should feel a click. The click is important as it confirms that the band was correctly applied

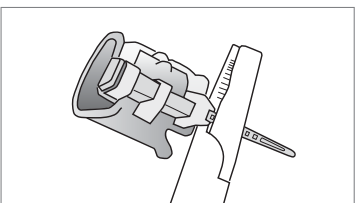

6. Once the leg band has been correctly applied, the end part of the locking pin can be cut off

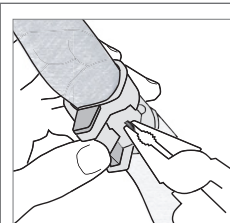

As the animal grows, the leg band can be widened by using pliers to remove one of the three steps.

### Note:

No information is available regarding the suitability of this device for use on kids and small goat breeds, so user discretion is advised.